

R-ITS-A4 Internally Threaded Sockets

Internally threaded socket for the attachment of suitable bolt or threaded rod. ETA Approved with pure epoxy resin

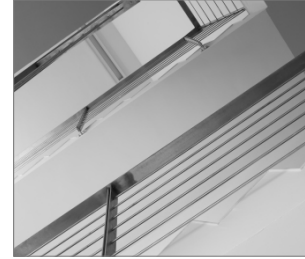
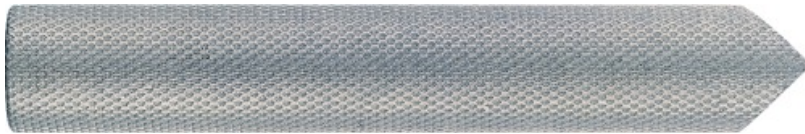

Product information

Features and benefits

- Allows removal of bolt to leave a re-usable socket in place
- High load-bearing capacity
- Close edge and spacing distances
- Expansion free functioning
- Available in zinc plated and stainless steel versions

Applications

- For fastening bolts
- Safety barriers
- Temporary works/formworks support systems

Base materials

Approved for use in:

- Non-cracked concrete C20/25-C50/60

Installation guide



1. After injecting resin, immediately insert the socket anchor, slowly and with a slight twisting motion until flush with surface
2. Remove excess resin, then leave anchorage undisturbed until curing time has elapsed
3. Fill hole with the required resin to the recommended fill level. (Follow the relevant instructions for the resin product)
4. [English]: Powoli włożyć tuleję do otworu z żywicą do osiągnięcia zalecanej głębokości kotwienia.
5. [English]: Pozostawić do zastygnięcia na wymagany dla aplikacji okres czasu.
6. Attach fixture and tighten the nut to the required torque.
7. After injecting resin, immediately insert the socket anchor, slowly and with a slight twisting motion until flush with surface
8. For installation with a drilling machine, insert the setting tool into socket and spin in using rotary hammer action
9. Remove excess resin, then leave anchorage undisturbed until curing time has elapsed

Product information

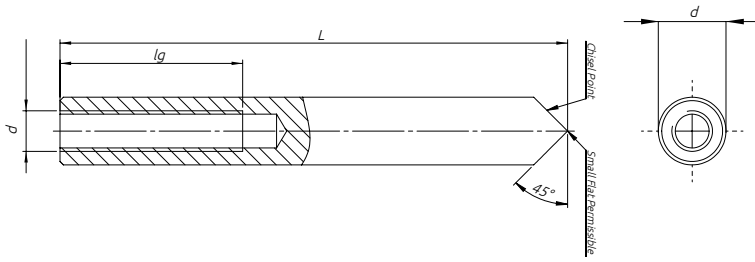

Size	Product Code	Anchor			Fixture
		Socket diameter	Length	Internal thread length	Hole diameter
		d	L	l _g	d _f
		[mm]	[mm]	[mm]	[mm]
M6	R-ITS-A4-06075	10	75	24	7
M8	R-ITS-A4-08075	12	75	25	9
	R-ITS-A4-08090	12	90	25	9
M10	R-ITS-A4-10075	16	75	30	12
	R-ITS-A4-10100	16	100	30	12
M12	R-ITS-A4-12100	16	100	35	14
M16	R-ITS-A4-16125	24	125	50	18

Product commercial data

Size	Product Code	Anchor	Quantity [pcs]			Weight [kg]			Bar Codes
		Length [mm]	Box	Outer	Pallet	Box	Outer	Pallet	
M6	R-ITS-A4-06075	75	10	10	3780	0.40	0.40	181.2	5906675087740
M8	R-ITS-A4-08075	75	10	10	7000	0.40	0.40	310.0	5906675087757
	R-ITS-A4-08090	90	10	160	1920	0.50	8.0	126.0	5906675087764
M10	R-ITS-A4-10075	75	10	160	1920	0.71	11.4	166.3	5906675283890
	R-ITS-A4-10100	100	10	160	1120	1.03	16.5	145.4	5906675283906
M12	R-ITS-A4-12100	100	6	6	2400	0.95	0.95	411.6	5906675283913
M16	R-ITS-A4-16125	125	6	6	2400	1.57	1.57	658.8	5906675087771