

## AT Tool for Interaset

Professional setting tool for easy setting of interaset cavity fixings. No screwdriver, no pressure, no fuss



### Product information

#### Features and benefits

- Setting tool used to pull the screw head and expanding the fixing body of interaset cavity fixings
- No screwdriver needed for installation

#### Applications

- Shelves and bathroom accessories on standard plasterboard
- Fixing light shelving, brackets and hooks

### Installation guide

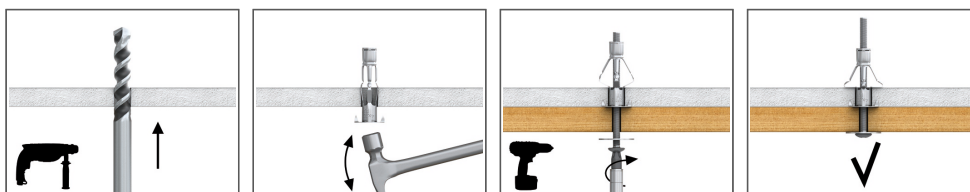

1. Drill a hole of required diameter.
2. Insert the fixing into the hole. Tap in lightly, ensuring that the anti-rotation lugs penetrate the face of the base material
3. With the hole drilled and the fixing inserted, the setting tool or screw driver is used to pull the screw head, thus expanding the fixing body

### Product information

Product Code	Use
AT-88RAWL	Professional

### Product commercial data

Product Code	Use	Quantity [pcs]			Weight [kg]			Bar Codes
		Box	Outer	Pallet	Box	Outer	Pallet	
AT-88RAWL	Professional	1	18	432	0.63	11.3	302.2	5906675906300