

SM Interaset

Interaset fixing for permanent anchorages in cavity walls. Zinc-plated metal fixing with metric screw



Product information

Features and benefits

- Due to extensive range the SM INTERASET is suitable for board building materials with a thickness 2-38mm, it allows for a number of different applications.
- The fixing can be installed using normal screw-driver, or installation pliers.
- One piece stamping, with integral thread and flange for increased reliability.
- Hinged legs designed to maximise load-bearing capacity
- Large contact area of expanded arms increases load-bearing capacity and security.
- Integral anti-rotation lugs
- Fixtures can be removed and re-fitted.
- Combination head screw supplied

Applications

- Shelves and bathroom accessories on standard plasterboard
- Radiators and kitchen cabinets on double thickness and tiled plasterboard
- Pictures
- Lamps
- Towel rails
- Curtain rails
- Mirrors

Base materials

Suitable for use in

- Plasterboard
- Gypsum Fibreboards
- Chipboard
- Oriented Strand Board

Installation guide

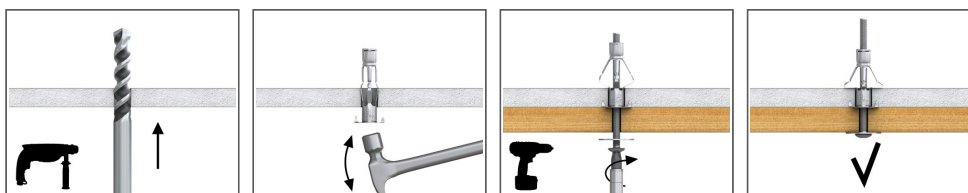

1. Drill a hole of required diameter.
2. Insert the fixing into the hole. Tap in lightly, ensuring that the anti-rotation lugs penetrate the face of the base material
3. With the hole drilled and the fixing inserted, the setting tool or screw driver is used to pull the screw head, thus expanding the fixing body

Product information

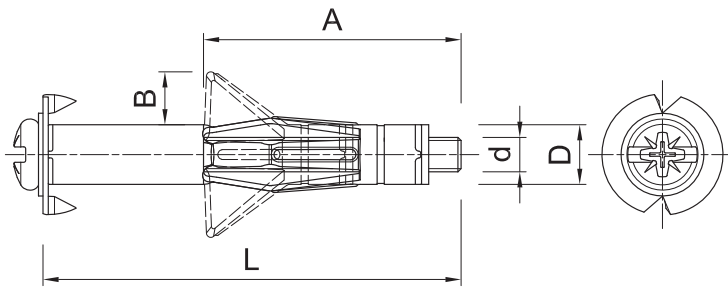

Product Code	Bolt		Steel sleeve			Fixture	Substrate thickness, min.	Fixture
	Diameter	Length	Diameter	Minimum clearance		Hole diameter		Max. thickness
	d	L	D	A	B	d _f	t _{fix}	
[mm]								
SM-04020	4	20	7	16	5	7	4	10
SM-04032	4	32	7	25	7	7	9.5	15
SM-04038	4	40	7	25	8	7	12	17
SM-04046	4	54	7	26	7	7	19	17
SM-04059	4	66	7	16	8	7	32	16
SM-05037	5	40	9	27	9	9	9.5	17
SM-05052	5	52	9	40	13	9	9.5	23
SM-05065	5	65	9	38	15	9	24	23
SM-06037	6	37	11	27	8	11	9.5	18
SM-06052	6	52	11	38	13	11	9.5	23
SM-06065	6	65	11	38	13	11	24	23
SM-06080	6	80	11	40	12	11	36	25
SM-08080	8	95	13	42	12	13	36	25
R-SM-04020	4	20	7	16	5	7	4	10
R-SM-04032	4	32	7	25	7	7	9.5	15
R-SM-04046	4	54	7	26	7	7	19	17
R-SM-04059	4	66	7	16	8	7	32	16
R-SM-05037	5	40	9	27	9	9	9.5	17
R-SM-05052	5	52	9	40	13	9	9.5	23
R-SM-05065	6	65	11	38	13	11	24	23
R-SM-06037	6	37	11	27	8	11	9.5	18
R-SM-06052	6	52	11	38	13	11	9.5	23
R-SM-06065	6	65	11	38	13	11	24	23
R-SM-06080	6	80	11	40	12	11	36	25
R-SM-08080	8	95	13	42	12	13	36	25

Installation data

Size			M4	M5	M6
Hole diameter in substrate	d ₀	[mm]	8	10	12
Min. spacing	s _{min}	[mm]	25	25	25
Min. edge distance	c _{min}	[mm]	25	25	25
Min. substrate thickness	h _{min}	[mm]	-	9.5	9.5

Product commercial data

Product Code	Substrate thickness, min. [mm]	Quantity [pcs]			Weight [kg]			Bar Codes
		Box	Outer	Pallet	Box	Outer	Pallet	
SM-04020	4	100	3200	76800	0.55	17.7	453.9	5906675191126
SM-04032	9.5	100	3200	76800	0.69	22.1	561.5	5906675191225
SM-04038	12	100	1600	38400	0.84	13.5	352.9	5906675160603
SM-04046	19	100	1600	38400	0.95	15.3	396.3	5906675191324
SM-04059	32	100	1600	38400	1.10	17.6	451.6	5906675191423
R-SM-04032K		100	3200	76800	0.79	25.3	636.0	5906675144047
R-SM-04032S		100	1200	28800	1.02	12.3	324.9	5906675144054
R-SM-04020	4	100	3200	76800	0.55	17.7	453.9	5906675172323
R-SM-04032	9.5	100	3200	76800	0.73	23.2	587.6	5906675172347
R-SM-04046	19	100	1600	38400	0.92	14.7	383.3	5906675004655
R-SM-04059	32	100	1600	38400	1.16	18.5	473.9	5906675004662
SM-05037	9.5	100	1600	38400	1.31	21.0	533.4	5906675191720
SM-05052	9.5	100	1200	28800	1.69	20.3	517.0	5906675191829
SM-05065	24	100	1200	28800	2.0	23.9	603.1	5906675191928
R-SM-05037	9.5	100	1600	38400	1.32	21.1	535.7	5906675172385
R-SM-05052	9.5	100	1600	38400	1.69	27.0	677.0	5906675172408
SM-06037	9.5	100	1200	28800	1.69	20.3	517.6	5906675192123
SM-06052	9.5	100	1200	28800	2.2	26.4	663.3	5906675192222
SM-06065	24	50	600	14400	1.36	16.3	420.2	5906675192321
SM-06080	36	50	600	14400	1.61	19.3	494.3	5906675192420
R-SM-05065	24	100	1200	28800	2.0	24.0	606.0	5906675172422
R-SM-06037	9.5	100	1200	28800	1.74	20.9	531.1	5906675172446
R-SM-06052	9.5	100	1200	28800	2.2	26.5	665.9	5906675172460
R-SM-06065	24	50	600	14400	1.37	16.5	425.7	5906675172484
R-SM-06080	36	50	600	14400	1.52	18.2	466.3	5906675004679
SM-08080	36	50	600	14400	2.8	33.2	827.2	5906675192727
R-SM-08080	36	50	600	14400	2.8	33.2	826.3	5906675158181