

Security control panel  
Model Name: **Ajax Hub**  
Wireless security control panel

The Hub coordinates operation of the Ajax security system supporting connection to up to 100 devices via the Jeweller wireless protocol, with an effective communication range of up to 2,000 meters without obstacles. The hub is controlled via a mobile application from any point of the world, and an Internet connection is required for operation. For reliability, two communication channels are used - wire Ethernet channel and the GSM network of a mobile operator (GPRS). If any problem occurs, both you and the security company will be notified immediately. The Hub is equipped with an accumulator unit providing up to 15 operational hours.

**IMPORTANT:** This Quick Start Guide contains general information about the Hub. Before using the device, we recommend to reviewing the User Manual on the website: [ajax.systems/support/hubs](http://ajax.systems/support/hubs)

**FUNCTIONAL ELEMENTS**

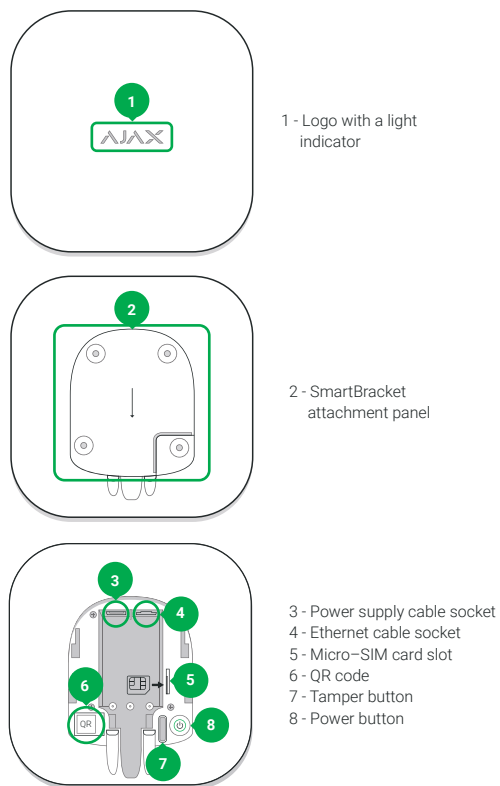

There should be a reliable communication with the Ajax security devices connected to the hub, as well as the Internet access - via the GSM (GPRS) network and/or Ethernet. It's desired hub to be hidden from direct view.

**Do not position the Hub:**

1. Outside the premises (outdoors).
2. Nearby any metal objects and mirrors causing radio signal attenuation or screening it.
3. In places with a high radio interference level.
4. Within any premises with the temperature beyond the range of permissible limits.

The SmartBracket panel is mounted on the surface with screws or any other no less reliable attachment hardware. The hub should be fixed on the panel with the bundled screws.

In installing and operating the Hub, follow the general electrical safety regulations for using electrical appliances, as well as the requirements of regulatory legal acts on electrical safety. It is strictly prohibited to disassemble the device under voltage and use it with the damaged power cord.

Do not disassemble or modify the Hub or its parts. This may disrupt the device or lead to its failure.

**CONNECTION AND SETTING UP**

1. Move the SmartBracket of the panel down, connect the power cable. Give the Hub access to the Internet by connecting the Ethernet cable and/or installing a SIM card of the mobile operator with the disabled PIN code.
2. Press and hold the Power button for 2 seconds to switch on the Hub – the logo will change the color to the green, when there are only one of the communication channels active or to white when both Ethernet and 2G/3G are connected to the server. If the logo continues to light red, follow the recommendations in the User Manual.
3. Install the mobile application **Ajax Security System**:



**CONNECTING THE AJAX TO A SECURITY COMPANY**

Connection to the central monitoring station is made via the Contact ID or SIA protocol. List of organizations supporting the Ajax system is available in the menu "Security companies" in the Hub settings.

**COMPLETE SET**

1. Hub
2. Power supply cable
3. Ethernet cable
4. Installation kit
5. GSM start package \*\*
6. Quick Start Guide

\*\* Available not in all countries.

**IMPORTANT INFORMATION**

This product can be used across all EU member states.

This device in compliance with the essential requirements and other relevant provisions of Directive 2014/53/EU. All essential radio test suites have been carried out.

**CE** CAUTION: RISK OF EXPLOSION IF BATTERY IS REPLACED BY AN INCORRECT TYPE. DISPOSE OF USED BATTERIES ACCORDING TO THE INSTRUCTIONS

Function	Operation frequency	Max RF output power	Limit
GPRS / EDGE 900	TX (Uplink): 880M-915MHZ RX (Downlink): 925M-960MHZ	GPRS 900: 33.66dBm EDGE 900: 27.57dBm	class 4 (33±3dBm)
GPRS / EDGE 1800	TX (Uplink): 1710M-1785MHZ RX (Downlink): 1805M-1880MHZ	GPRS 1800: 29.61dBm EDGE 1800: 25.78dBm	class 1 (30±3dBm)

Maximum number of connected devices	100
Maximum number of groups	9
Maximum number of the Hub users	50
Power supply	110 - 240 V
Accumulator unit (up to 15 hours of autonomous operation *)	Li-Ion 2 A×h
Anti-tamper switch	Yes
Frequency band	868.0-868.6 MHz
Effective radiated power	8.20 dBm / 6.60 mW (limit 25 mW)
Modulation	GFSK
Radio signal	Up to 2,000 m (any obstacles absent)
Communication channels	GGSM 850/900/1800/1900 MHz GPRS, Ethernet
Operating temperature range	From +5°C to +40°C
Overall dimensions	163 x 163 x 36 mm
Weight	350 g

\* In case of inactive Ethernet connection.

**WARRANTY**

Warranty for Ajax devices is valid for two years after the purchase date and does not apply to the supplied battery. If the device does not work correctly, you should first contact the support service—in half of the cases, technical issues can be solved remotely!

The full text of the warranty is available on the website: [ajax.systems/warranty](http://ajax.systems/warranty)

User Agreement: [ajax.systems/end-user-agreement](http://ajax.systems/end-user-agreement)

Technical support: [support@ajax.systems](mailto:support@ajax.systems)