



REF.

2W52733

2W52732

MANDRIS METALDURO

REF.2W52721

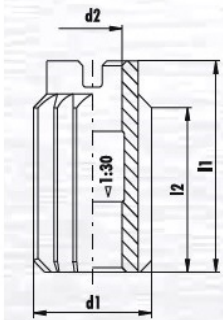

**Aufsteckreibahlen HSS-E, DIN 219**  
 Shell Reamers HSS-E, DIN 219

Bestell-Nr. / List-No.	733	732
Schneidstoff / Cutting material	HSS-E	HSS-E
Oberfläche / Surface	┘	┘
Form	B / spiral	C / quick spiral
Rabattgruppe / Discount group	600	600

d1 mm	l1 mm	l2 mm	d2 mm	€ pro Stück / per piece	€ pro Stück / per piece
20,00	50	40	10		
21,00	50	40	10		
22,00	50	40	10		
23,00	50	40	10		
24,00	50	40	10		
25,00	45	32	13		
26,00	45	32	13		
27,00	45	32	13		
28,00	45	32	13		
29,00	45	32	13		
30,00	45	32	13		
31,00	50	36	16		
32,00	50	36	16		
33,00	50	36	16		
34,00	50	36	16		
35,00	50	36	16		
36,00	56	40	19		
37,00	56	40	19		
38,00	56	40	19		
39,00	56	40	19		
40,00	56	40	19		
41,00	56	40	19		
42,00	56	40	19		
43,00	63	45	22		
44,00	63	45	22		
45,00	63	45	22		
46,00	63	45	22		
47,00	63	45	22		
48,00	63	45	22		
49,00	63	45	22		
50,00	63	45	22		
52,00	71	50	27		
55,00	71	50	27		
56,00	71	50	27		
58,00	71	50	27		
60,00	71	50	27		
62,00	80	56	32		
65,00	80	56	32		
68,00	80	56	32		
70,00	80	56	32		
72,00	90	63	40		
75,00	90	63	40		
78,00	90	63	40		
80,00	90	63	40		
82,00	90	63	40		
85,00	90	63	40		
88,00	100	71	50		
90,00	100	71	50		
92,00	100	71	50		
95,00	100	71	50		
98,00	100	71	50		
100,00	100	71	50		

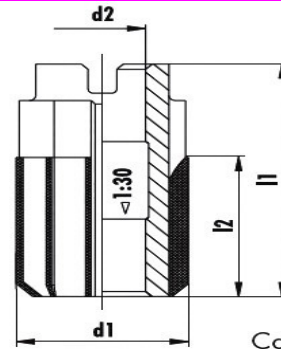

Carbide tipped, DIN 8054

Bestell-Nr. / List-No.	721
Schneidstoff / Cutting material	K10
Oberfläche / Surface	┘
Form	A / straight
Rabattgruppe / Discount group	600

d1 mm	l1 mm	l2 mm	d2 mm
30,00	45	30	13
32,00	45	30	13
35,00	45	30	13
36,00	50	30	16
40,00	50	30	16
42,00	50	30	16
45,00	50	30	16
50,00	56	30	19
55,00	63	30	22
60,00	63	30	22

**SUPORTES CONE MORSE DIN-217 REF.2W52730**

**Aufsteckhalter, DIN 217**  
 Arbors, DIN 217

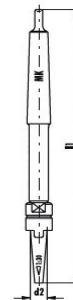

Bestell-Nr. / List-No.	730
Schneidstoff / Cutting material	
Oberfläche / Surface	┘
Rabattgruppe / Discount group	600

Nenngröße size	d2 mm	l1 mm	MK	Einsatzbereich Range of application	
				DIN 219	DIN 8054
1	10	255	2	20 - 24	
2	13	295	3	25 - 30	30 - 35
3	16	310	3	31 - 35	36 - 45
4	19	350	4	36 - 42	46 - 53
5	22	370	4	43 - 50	54 - 60
6	27	390	5	51 - 60	
7	32	440	5	61 - 71	
8	40	460	5	72 - 85	
9	50	480	5	86 - 100	