

		USO GERAL		ESQUERDOS		HSSE		INOX		LATÃO				
<b>M</b>	Metric coarse thread ISO DIN 13	Round Dies for general use		Round Dies for general use Left Hand		Round Dies for higher demands		Round Dies for stainless steels		Round Dies for brass				
		<p>material: HSS ISO-6g Chamfer: 1,5 threads right hand thread</p>		<p>material: HSS ISO-6g Chamfer: 1,5 threads left hand thread</p>		<p>material: HSSE ISO-6g Chamfer: 1,5 threads right hand thread with spiral entry</p>		<p>material: HSSE ISO-6g Chamfer: 2 threads right hand thread lapped with spiral entry</p>		<p>material: HSS ISO-6g Chamfer: 1,25 threads right hand thread lapped with spiral entry</p>				
M	D	D1	H	D2	No.	€	No.	€	No.	€	No.	€		
M 1 x 0,25	1,0	16	5	0,96	111401001	12,74								
M 1,1 x 0,25	1,1	16	5	1,05	111401002	12,74								
M 1,2 x 0,25	1,2	16	5	1,15	111401003	12,74								
M 1,4 x 0,3	1,4	16	5	1,36	111401004	12,74			111405001	94,47				
M 1,6 x 0,35	1,6	16	5	1,55	111401005	12,74			111405002	91,47				
M 1,7 x 0,35	1,7	16	5	1,64	111401006	12,74			111405003	91,47				
M 1,8 x 0,35	1,8	16	5	1,75	111401007	12,74								
M 2 x 0,4	2,0	16	5	1,95	111401008	11,08	111402001	19,94			111405004	74,36	111409001	71,66
M 2,2 x 0,45	2,2	16	5	2,15	111401009	11,08								
M 2,3 x 0,4	2,3	16	5	2,23	111401010	11,08					111405005	74,36		
M 2,5 x 0,45	2,5	16	5	2,42	111401011	11,08					111405006	64,75	111409002	62,06
M 2,6 x 0,45	2,6	16	5	2,53	111401012	11,08					111405007	67,45	111409003	62,06
M 3 x 0,5	3,0	20	5	2,92	111401013	5,32	111402002	9,19	111404001	9,02	111405008	22,84	111409004	46,53
M 3,5 x 0,6	3,5	20	5	3,41	111401014	8,20					111405009	45,69	111409005	63,84
M 4 x 0,7	4,0	20	5	3,90	111401015	5,32	111402003	9,19	111404002	9,02	111405010	22,52	111409006	44,30
M 4,5 x 0,75	4,5	20	7	4,40	111401016	8,20								
M 5 x 0,8	5,0	20	7	4,90	111401017	5,65	111402004	9,87	111404003	9,35	111405011	23,26	111409007	39,84
M 5 x 0,9	5,0	20	7	4,89	111401018	8,36								
M 5,5 x 0,9	5,5	20	7	5,44	111401019	5,65								
M 6 x 1,0	6,0	20	7	5,88	111401020	5,65	111402005	9,87	111404004	9,35	111405012	23,26	111409008	39,84
M 7 x 1,0	7,0	25	9	6,88	111401021	8,87					111405013	66,31	111409009	55,72
M 8 x 1,25	8,0	25	9	7,86	111401022	5,98	111402006	11,42	111404005	13,26	111405014	25,99	111409010	44,30
M 9 x 1,25	9,0	25	9	8,86	111401023	10,08								
M 10 x 1,5	10,0	30	11	9,85	111401024	8,86	111402007	14,96	111404006	18,82	111405015	33,81	111409011	53,50
M 11 x 1,5	11,0	30	11	10,85	111401025	12,19								
M 12 x 1,75	12,0	38	14	11,83	111401026	14,41	111402008	21,28	111404007	29,73	111405016	38,64	111409012	71,05
M 14 x 2,0	14,0	38	14	13,82	111401027	14,41	111402009	24,38	111404008	29,73	111405017	38,64	111409013	88,60
M 15 x 2,0	15,0	38	14	14,91	111401028	22,17								
M 16 x 2,0	16,0	45	18	15,82	111401029	22,17	111402010	33,79	111404009	44,88	111405018	61,95		
M 18 x 2,5	18,0	45	18	17,79	111401030	22,17	111402011	33,79	111404010	44,88	111405019	64,05		
M 19 x 2,5	19,0	45	18	18,89	111401031	32,14								
M 20 x 2,5	20,0	45	18	19,79	111401032	22,17	111402012	33,79	111404011	44,88	111405020	65,10		
M 22 x 2,5	22,0	55	22	21,79	111401033	43,22	111402013	50,97	111404012	79,74	111405021	145,16		

**USO GERAL    ESQUERDOS    HSSE    INOX    LATÃO**

**M** Metric coarse thread  
ISO DIN 13

**Round Dies for general use**

**Round Dies for general use Left Hand**

**Round Dies for higher demands**

**Round Dies for stainless steels**

**Round Dies for brass**

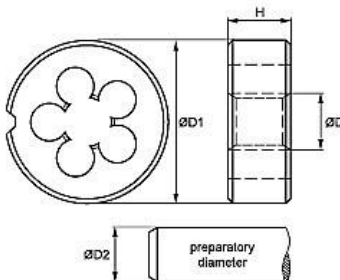
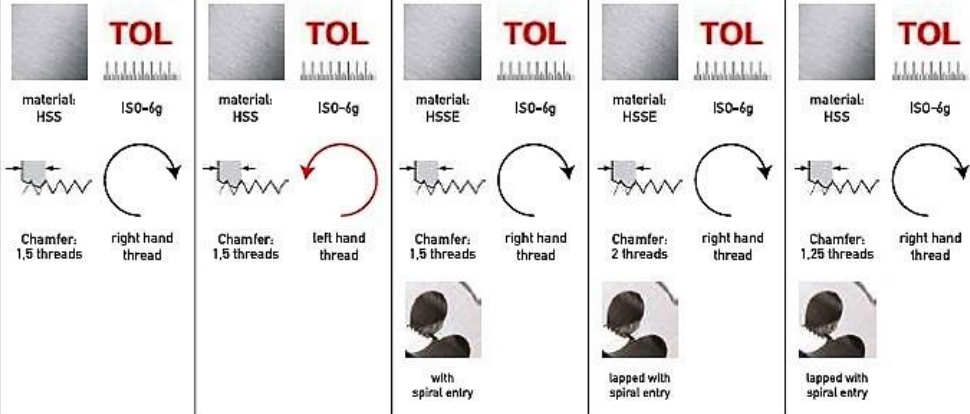

M	D	D1	H	D2	No.	€	No.	€	No.	€	No.	€	No.	€
M 24 x 3,0	24,0	55	22	23,76	111401034	43,22	111402014	51,24	111404013	79,74	111405022	145,16		
M 27 x 3,0	27,0	65	25	26,76	111401035	58,17	111402015	92,44	111404014	118,06	111405023	250,76		
M 30 x 3,5	30,0	65	25	29,73	111401036	58,17	111402016	92,44	111404015	118,06	111405024	194,25		
M 33 x 3,5	33,0	65	25	32,73	111401037	62,05	111402017	92,44						
M 36 x 4,0	36,0	65	25	35,70	111401038	62,05	111402018	92,44						
M 39 x 4,0	39,0	75	30	38,70	111401039	100,85	111402019	155,93						
M 42 x 4,5	42,0	75	30	41,68	111401040	100,85	111402020	155,93						
M 45 x 4,5	45,0	90	36	44,68	111401041	172,86	111402021	245,01						
M 48 x 5,0	48,0	90	36	47,66	111401042	172,86	111402022	245,01						
M 52 x 5,0	52,0	90	36	51,66	111401043	172,86	111402023	245,01						
M 56 x 5,5	56,0	105	36	55,65	111401044	346,84								
M 60 x 5,5	60,0	105	36	59,65	111401045	346,84								
M 64 x 6,0	64,0	120	36	63,62	111401046	459,86								
M 68 x 6,0	68,0	120	36	67,62	111401047	459,86								
M 72 x 6,0	72,0	120	36		111401048	*								
M 76 x 6,0	76,0	120	36		111401049	*								
M 80 x 6,0	80,0	120	36		111401050	*								
M 84 x 6,0	84,0	130	36		111401051	*								
M 88 x 6,0	88,0	140	36		111401052	*								
M 90 x 6,0	90,0	140	36		111401053	*								
M 92 x 6,0	92,0	140	36		111401054	*								
M 96 x 6,0	96,0	140	36		111401055	*								
M 100 x 6,0	100,0	150	36		111401056	*								

\* on request

**CAÇONETES TOLERANCIA 6e**

**CAÇONETES DIAMETROS 25mm**

M	D	D1	H	D2	No.	€
M 3 x 0,5	3,0	20	5	2,89	111421001	8,87
M 4 x 0,7	4,0	20	5	3,87	111421002	8,87
M 5 x 0,8	5,0	20	7	4,86	111421003	9,20
M 6 x 1,0	6,0	20	7	5,85	111421004	9,20
M 8 x 1,25	8,0	25	9	7,83	111421005	9,87
M 10 x 1,5	10,0	30	11	9,81	111421006	12,75
M 12 x 1,75	12,0	38	14	11,81	111421007	19,72
M 14 x 2,0	14,0	38	14	13,87	111421008	25,49
M 16 x 2,0	16,0	45	18	15,87	111421009	38,34
M 18 x 2,5	18,0	45	18	17,75	111421010	38,34
M 20 x 2,5	20,0	45	18	19,75	111421011	38,34

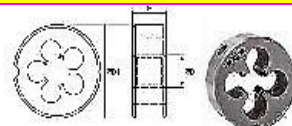

M	D	D1	H	D2	No.	€
M 3 x 0,5	3,0	25	9	2,92	111422001	6,09
M 4 x 0,7	4,0	25	9	3,90	111422002	6,09
M 5 x 0,8	5,0	25	9	4,90	111422003	6,09
M 6 x 1,0	6,0	25	9	5,88	111422004	6,09
M 8 x 1,25	8,0	25	9	7,86	111422005	6,09
M 10 x 1,5	10,0	25	9	9,85	111422006	6,09
M 12 x 1,75	12,0	25	9	11,83	111422007	6,09

**CAÇONETES SEXTAVADOS – ROSCA>**

**Direita**

**Esquerda**

**M** Metric coarse thread  
ISO DIN 13  
**Hexagon Die Nuts**

Hexagon Die Nuts  
for general use

Hexagon Die Nuts  
for general use  
Left Hand

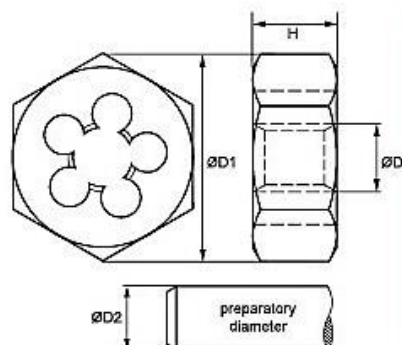
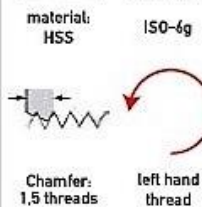
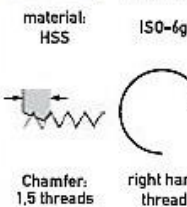
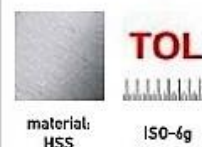

M	D	D1	H	D2	No.	€	No.	€
M 3 x 0,5	3,0	19	5	2,92	111501001	11,08	111502001	13,36
M 3,5 x 0,6	3,5	19	5	3,41	111501002	11,08		
M 4 x 0,7	4,0	19	5	3,90	111501003	11,08	111502002	13,36
M 5 x 0,8	4,5	19	7	4,40	111501004	11,08	111502003	14,48
M 6 x 1,0	6,0	19	7	5,88	111501005	11,08	111502004	14,48
M 7 x 1,0	7,0	22	9	6,88	111501006	12,19		
M 8 x 1,25	8,0	22	9	7,86	111501007	12,19	111502005	16,15
M 9 x 1,25	9,0	22	9	8,86	111501008	12,19		
M 10 x 1,5	10,0	27	11	9,85	111501009	14,41	111502006	22,83
M 11 x 1,5	11,0	27	11	10,85	111501010	14,41		
M 12 x 1,75	12,0	36	14	11,83	111501011	19,95	111502007	35,08
M 14 x 2,0	14,0	36	14	13,82	111501012	19,95	111502008	35,08
M 16 x 2,0	16,0	41	18	15,82	111501013	28,25	111502009	54,57
M 18 x 2,5	18,0	41	18	17,79	111501014	28,25	111502010	54,57
M 20 x 2,5	20,0	41	18	19,79	111501015	28,25	111502011	54,57
M 22 x 2,5	22,0	50	22	21,79	111501016	47,65	111502012	74,06
M 24 x 3,0	24,0	50	22	23,76	111501017	57,62	111502013	74,06
M 27 x 3,0	27,0	60	25	26,76	111501018	87,54	111502014	113,60
M 30 x 3,5	30,0	60	25	29,73	111501019	87,54	111502015	113,60
M 33 x 3,5	33,0	60	25	32,73	111501020	87,54	111502016	113,60
M 36 x 4,0	36,0	60	25	35,70	111501021	87,54	111502017	113,60
M 39 x 4,0	39,0	70	30	38,70	111501022	145,18	111502018	189,34
M 42 x 4,5	42,0	70	30	41,68	111501023	145,18	111502019	189,34
M 45 x 4,5	45,0	85	36	44,68	111501024	200,57	111502020	268,41
M 48 x 5,0	48,0	85	36	47,66	111501025	200,57	111502021	268,41
M 52 x 5,0	52,0	85	36	51,66	111501026	200,57	111502022	268,41
M 56 x 5,5	56,0	100	36	55,65	111501027	354,59		
M 60 x 5,5	60,0	100	36	59,65	111501028	354,59		
M 64 x 6,0	64,0	100	36	63,62	111501029	354,59		
M 68 x 6,0	68,0	115	36	67,62	111501030	459,87		

**OUTRAS CONFIGURAÇÕES – FAVOR CONSULTAR**

**ON REQUEST ANY OTHER EXECUTION**